



# MATERIAL LIST (12'x12' Square Deck)

16' 16'

QUANTITY	SIZE	DESCRIPTION	TOTAL LENGTH
1	4x4x10'	Post, cut for 9 posts	10
6	2x6x12'	Girder	12' 96'
12	2x6x12'	Deck & rim joists	144' 192'
4	2x8x12'	Facia	48' 64'
25	2x6x12' or (5/4x6x12)	Decking	300' 400'
<b>(For optional stairs):</b>			
1	2x10x8'	Stair stringer	13
1	2x6x10'	Stair riser, cut	10
1	2x12x12'	Stair tread	24

QUANTITY	SIZE	DESCRIPTION
16	LUS26	Joist to rim joist hangers
18	DJT14	Deck joist ties
20	H4	Joist anchors
250	DBT1	Deck board ties
8	A35	Framing anchors for rim joist
<b>(Base Option A - Pre-cast Pier Blocks with Poured Footings):</b>		
9	ABE44	Post bases (or AB44, ABA44 or BC40 bases)
<b>(Base Option B - Poured Footings):</b>		
9	PB44	Post bases (or CB44, CBS44, EPB44, EPB44A, LCB44 or PBS44)
<b>(For optional stairs):</b>		
2	A35	Staircase riser and rim joist corner anchors
6	TA10	Staircase angles

QUANTITY	SIZE	DESCRIPTION
10d		Common galvanized nails for fascia
16d		Common galvanized nails for DJT14, ABE44, (or PB44), and rim joist
10d x 1 1/2"	Simpson Strong-Tie	Common galvanized nails for DBT1, LUS26
8d x 1 1/2"	Simpson Strong-Tie	Common galvanized nails for H4
3/8"		Lag screws with washers for ledger
12		
<b>(For optional stairs):</b>		
36	1/4" x 1 1/2"	Lag screws for TA10

QUANTITY	DESCRIPTION
9	Pre-cast deck piers (For Option A Bases)
2	Concrete for footings and step pad
2	Deck finishing (optional)

QUANTITY	SIZE	DESCRIPTION	TOTAL LENGTH
4	2x6x12'	Railing top	48' 64'
24	2x2x14'	Balusters and cleats	112
3	4x4x12'	Posts, cut for 12 railings	36' 48'
4	2x4x12'	Railing stringers	32
13	DPT6"	Deck post tie	
48	DRT8	Deck railing tie	

(\* 2x4 lumber may be substituted, use DPT5 for 2x4 posts)  
NOTE: For other size decks requiring larger posts, girders and joists, Strong-Tie connectors are available.

## Deck Plans- Table 1

The following information will assist you in laying out a custom deck different from the 12'x12' version. Please consult your lumber dealer, qualified contractor or structural engineer when building a custom-sized deck.  
For proper support of a deck, you should look at three different factors: height, distance between support posts and joist size.  
The posts raise the deck above ground. The girders attach to the top of posts and provide support to the joists. The joists attach perpendicularly between girders and support the deck planking.

### WOOD SPECIES GROUP Z: Western Pines & Cedars • Redwoods & Spruces

JOIST SPAN	GIRDER SPAN																				
	4 x 4 to 8' ht.				4 x 6 to 8' ht.				6 x 6 to 8' ht.												
	5'	6'	7'	8'	5'	6'	7'	8'	5'	6'	7'	8'									
4 x 4 to 8' ht.	A	a	A	a	B	a	B	a	C	or	E	a	C	or	F	a					
4 x 6 to 8' ht.	A	a	B	a	B	a	C	or	E	a	D	or	F	a	D	or	F	a			
6 x 6 to 8' ht.	B	b	B	b	C	or	E	b	C	or	F	b	D	or	F	b	D	or	F	b	
6 x 6 to 8' ht.	B	b	C	or	E	b	C	or	F	b	D	or	F	b	G		G		G		
6 x 6 to 8' ht.	9'	C	c	C	c	C	c	D	or	F	c	F	c	G	c	G	c	G	c	G	c
6 x 6 to 8' ht.	10'	C	c	C	c	C	c	D	or	F	c	D	or	F	c	G	c	G	c	G	c
6 x 6 to 8' ht.	11'	D	d	D	d	D	d	D	d	G	d	G	d	G	d						
Maximum Area Table for Post of:												4 x 4	4 x 6	6 x 6							
Maximum Square Foot Area												@ 8' ht.	60	72	96						
												@ 10' ht.	48	60	84						
												@ 12' ht.	36	48	72						

### WOOD SPECIES GROUP X: Douglas Fir • Southern Pine

JOIST SPAN	GIRDER SPAN																
	4 x 4 to 8' ht.				4 x 6 to 8' ht.				6 x 6 to 8' ht.								
	5'	6'	7'	8'	5'	6'	7'	8'	5'	6'	7'	8'					
4 x 4 to 8' ht.	A	a	A	a	B	a	B	a	C	a	C	a	C	a	C	a	
4 x 6 to 8' ht.	A	a	B	a	B	a	C	a	C	a	D	a	D	a	D	a	
4 x 6 to 8' ht.	A	a	B	b	B	b	C	b	C	b	D	b	D	b	F	b	
4 x 6 to 8' ht.	A	a	B	b	B	b	C	b	C	b	D	b	D	b	F	b	
4 x 6 to 8' ht.	11'	A	c	B	c	C	c	C	c	D	c	D	c	F	c	G	c
4 x 6 to 8' ht.	12'	A	c	B	c	C	c	C	c	D	c	D	c	F	c	G	c
6 x 6 to 8' ht.	13'	F	c	F	c	F	c	G	d	G	d	G	d				
6 x 6 to 8' ht.	14'	G	d	G	d	G	d	G	d	G	d	G	d				
Maximum Area Table for Post of:												4 x 4	4 x 6	6 x 6			
Maximum Square Foot Area												@ 8' ht.	72	120	168		
												@ 10' ht.	60	108	156		
												@ 12' ht.	36	84	132		

**LEGEND:**  
For Groups Z & X  
**Girder Size**  
A : 4 x 6  
B : 4 x 8  
C : 4 x 10  
D : 4 x 12  
**Joist Size**  
a : 2 x 6 @ 24" on centers  
b : 2 x 8 @ 24" on centers  
c : 2 x 10 @ 24" on centers  
d : 2 x 12 @ 24" on centers

NOTE: All sizes are based on 40 pounds per square foot live load and 10 pounds per square foot dead load. The tables serve as guides only; Simpson Strong-Tie claims no responsibility for the numbers presented. When building a deck consult with a qualified contractor or structural engineer.

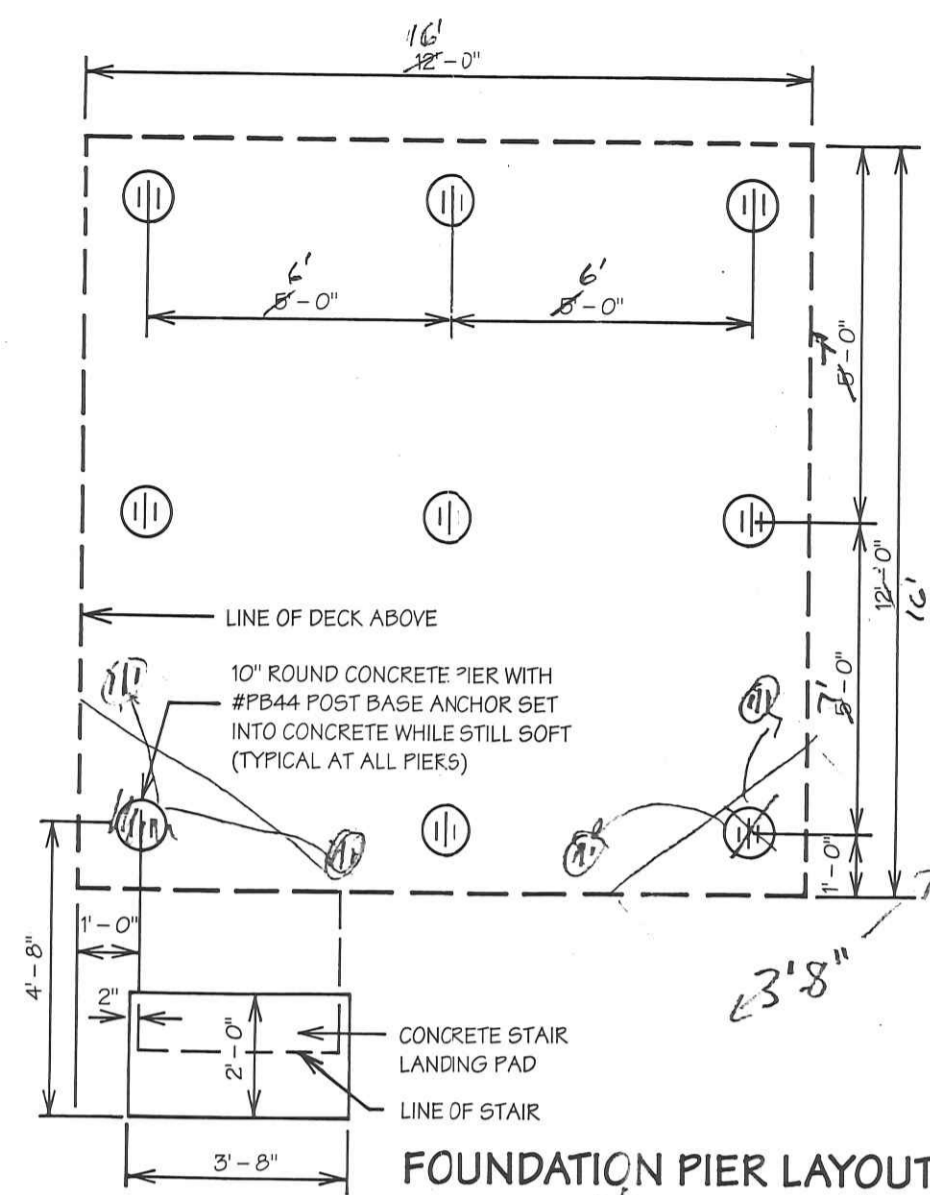

FOUNDATION PIER LAYOUT PLAN  
Add TWO MORE PIERS

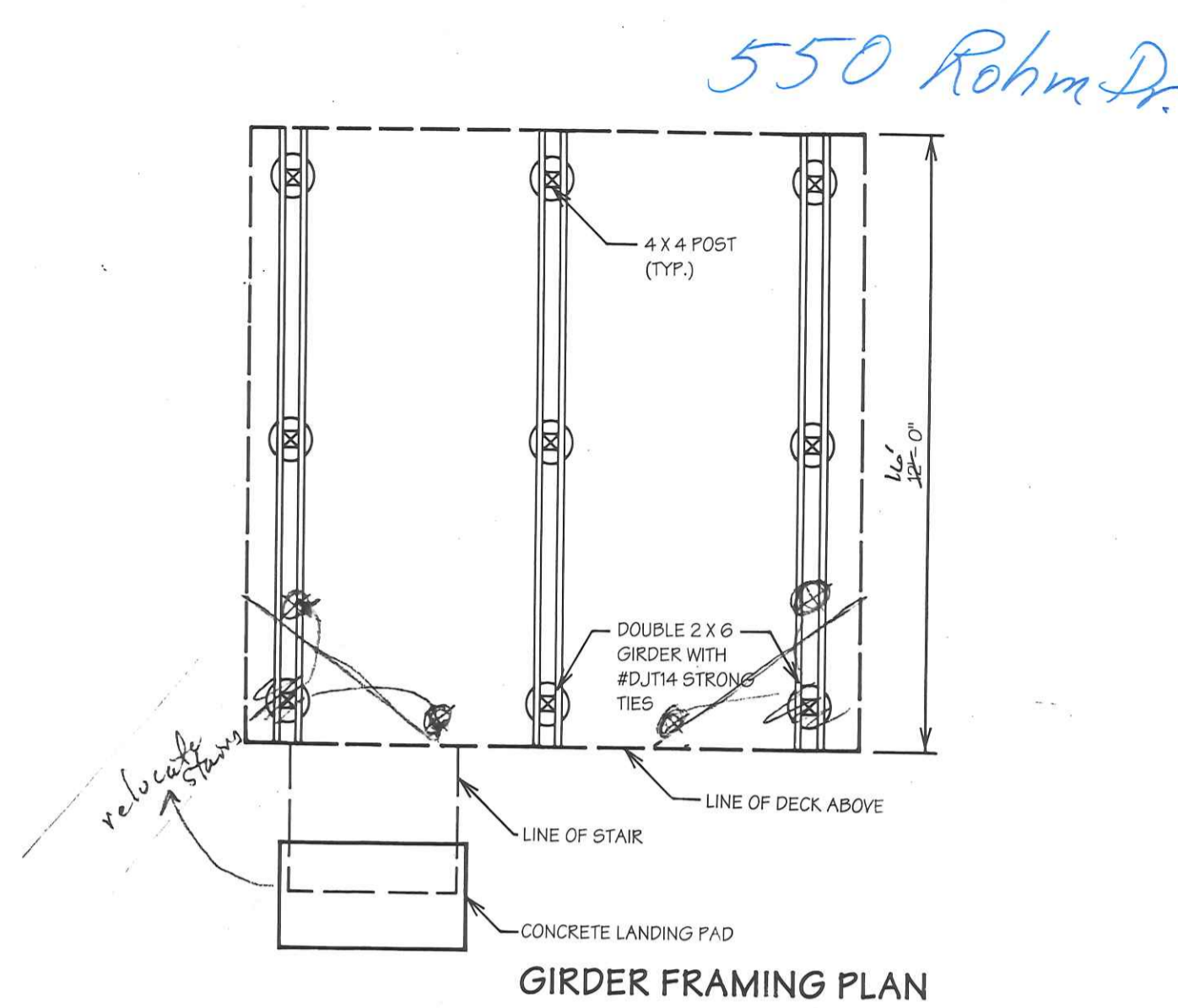

GIRDER FRAMING PLAN

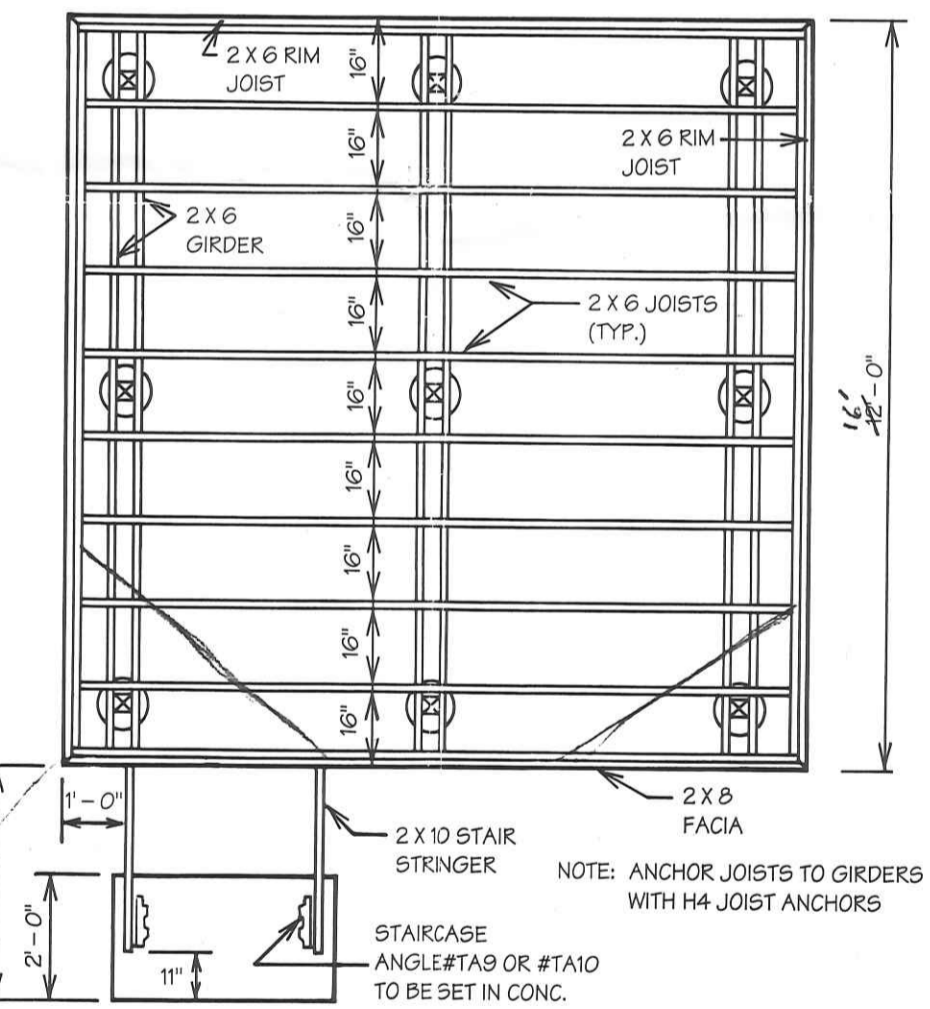

DECK FRAMING PLAN

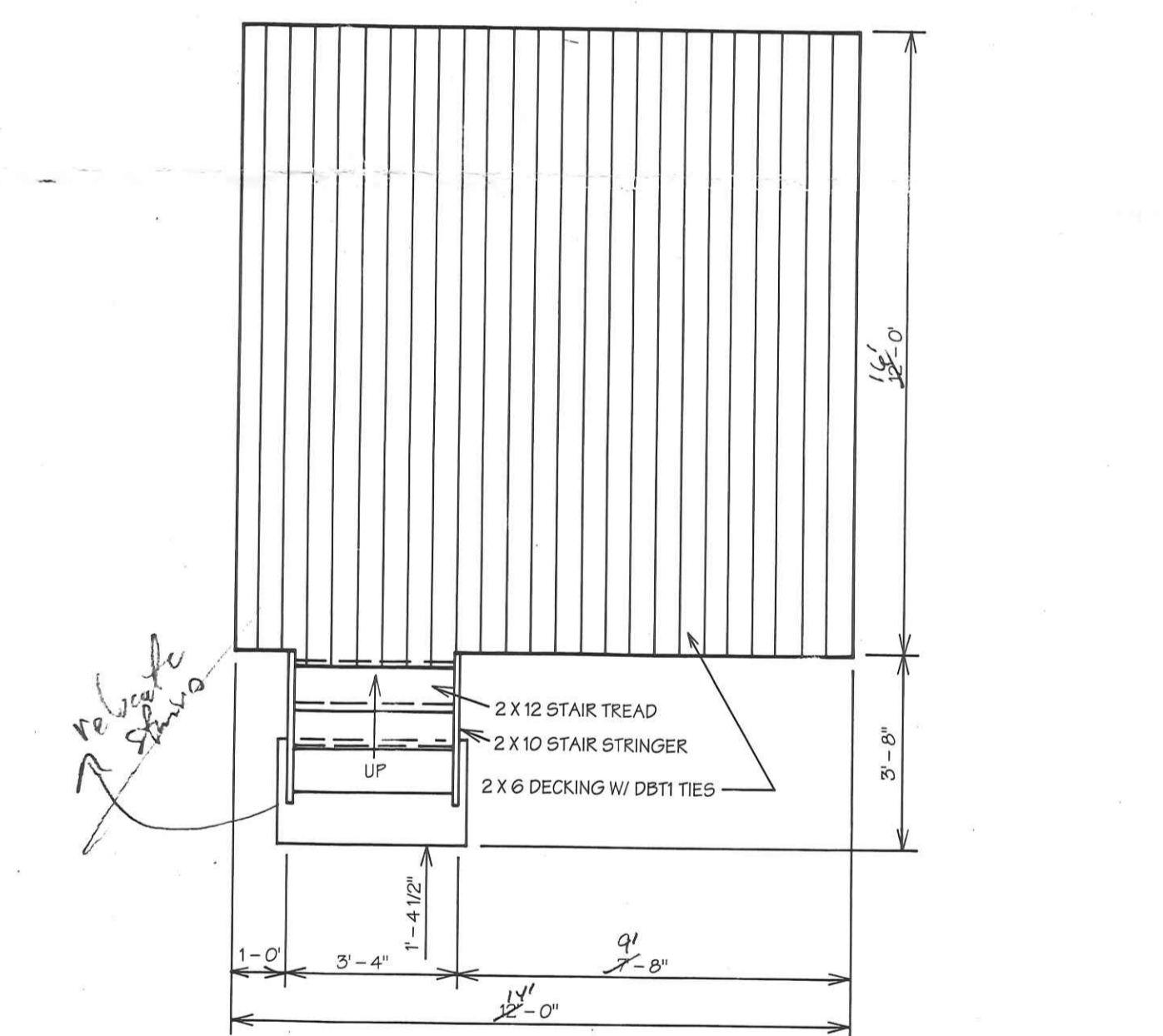

DECK PLAN

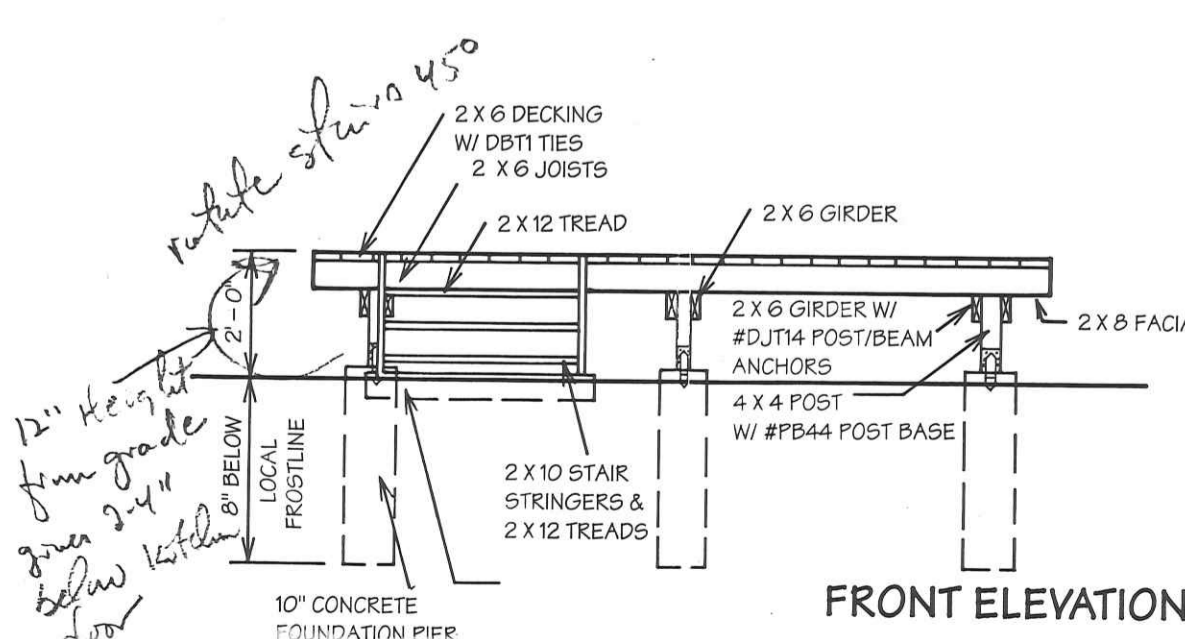

FRONT ELEVATION

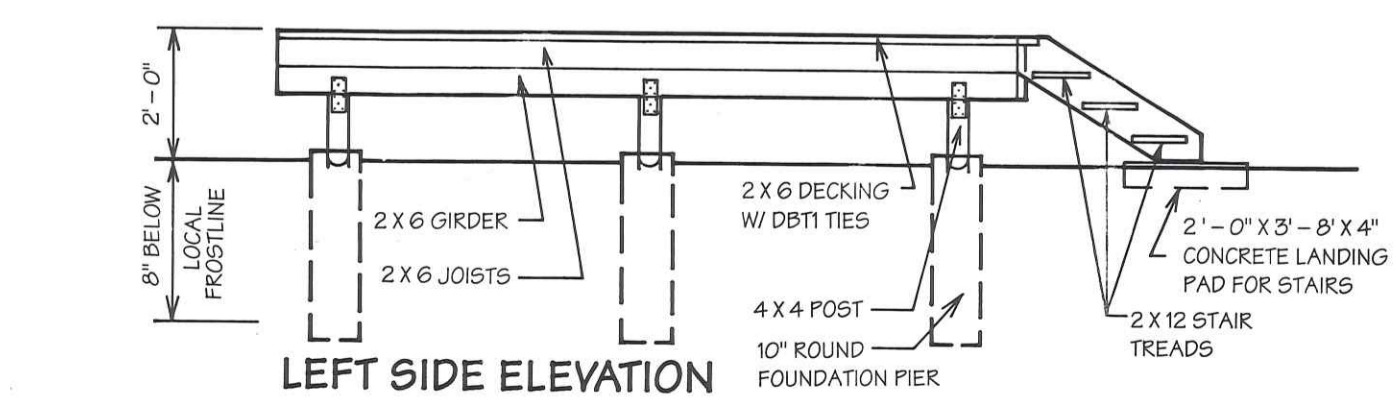

LEFT SIDE ELEVATION

550 Rohm Dr.

12" Height from grade over 24" below kitchen door  
10" BELOW LOCAL FROSTLINE  
10" CONCRETE FOUNDATION PIER



BGW-4882  
Ford Under-Station Heavy Duty

# CHOOSE THE DEK-BLOCK THAT'S RIGHT FOR YOU!

**8'x8' • 8'x12' • 8'x16' • 8'x20' • 8'x24' • 8'x32'**

MATERIALS	8'x8'	8'x12'	8'x16'	8'x20'	8'x24'	8'x32'
DEK-BLOCK BRAND PIERS	12	12	20	20	24	32
<b>SUPPORT BOARDS</b>						
8 FOOT 2"x6", TREATED LUMBER	4	—	8	—	—	4
10 FOOT 2"x6", TREATED LUMBER	—	—	—	8	—	—
12 FOOT 2"x6", TREATED LUMBER	—	4	—	—	8	8
<b>END BOARDS</b>						
8 FOOT 2"x6", TREATED LUMBER	2	2	2	2	2	2
<b>SURFACE BOARDS</b>						
8 FOOT 2"x6", TREATED LUMBER	18	26	34	43	50	68
*OPTIONAL POST'S FOR 30" ELEVATION						
8 FOOT 4"x4", TREATED LUMBER	2	2	4	4	5	7
2 1/2" GALV. DECK SCREWS	3 LBS	5 LBS	7 LBS	7 LBS	8 LBS	14 LBS
STAIN OR SEALER, GALLONS	1	1	2	2	2	4
METAL TRUSS PLATES	—	—	8	8	8	16

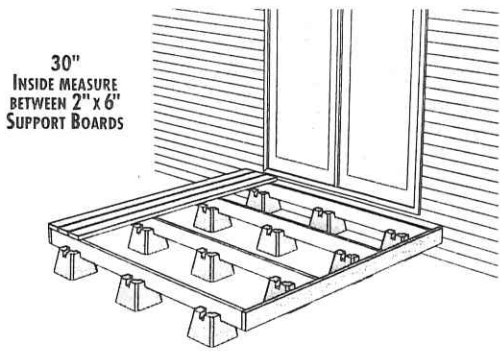

**12'x12' • 12'x16' • 12'x20' • 12'x24' • 12'x32'**

MATERIALS	12'x12'	12'x16'	12'x20'	12'x24'	12'x32'
DEK-BLOCK BRAND PIERS	18	30	30	36	48
<b>SUPPORT BOARDS</b>					
8 FOOT 2"x6", TREATED LUMBER	—	12	—	—	6
10 FOOT 2"x6", TREATED LUMBER	—	—	12	—	—
12 FOOT 2"x6", TREATED LUMBER	6	—	—	12	12
<b>END BOARDS</b>					
12 FOOT 2"x6", TREATED LUMBER	2	2	2	2	2
<b>SURFACE BOARDS</b>					
12 FOOT 2"x6", TREATED LUMBER	26	34	43	50	68
*OPTIONAL POST'S FOR 30" ELEVATION					
8 FOOT 4"x4", TREATED LUMBER	3	5	5	6	9
2 1/2" GALV. DECK SCREWS	6 LBS	8 LBS	9 LBS	10 LBS	16 LBS
STAIN OR SEALER, GALLONS	2	2	3	3	4
METAL TRUSS PLATES	—	12	12	12	24

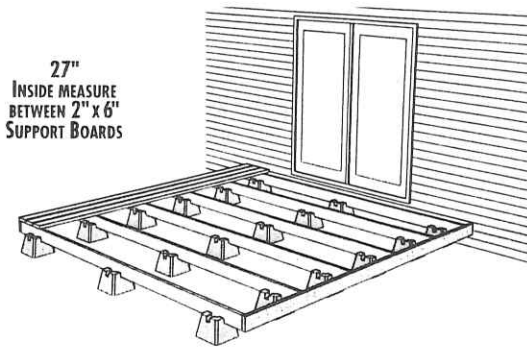

**16'x16' • 16'x20' • 16'x24' • 16'x32' • 16'x40'**

MATERIALS	16'x16'	16'x20'	16'x24'	16'x32'	16'x40'
DEK-BLOCK BRAND PIERS	35	35	42	56	63
<b>SUPPORT BOARDS</b>					
8 FOOT 2"x6", TREATED LUMBER	—	—	—	—	7
10 FOOT 2"x6", TREATED LUMBER	—	14	—	—	—
12 FOOT 2"x6", TREATED LUMBER	—	—	14	—	—
16 FOOT 2"x6", TREATED LUMBER	7	—	—	14	14
<b>END BOARDS</b>					
16 FOOT 2"x6", TREATED LUMBER	2	2	2	2	2
<b>SURFACE BOARDS</b>					
16 FOOT 2"x6", TREATED LUMBER	34	43	50	68	85
*OPTIONAL POST'S FOR 30" ELEVATION					
8 FOOT 4"x4", TREATED LUMBER	6	6	7	11	12
2 1/2" GALV. DECK SCREWS	9 LBS	11 LBS	12 LBS	15 LBS	22 LBS
STAIN OR SEALER, GALLONS	4	4	4	6	9
METAL TRUSS PLATES	—	14	14	28	28

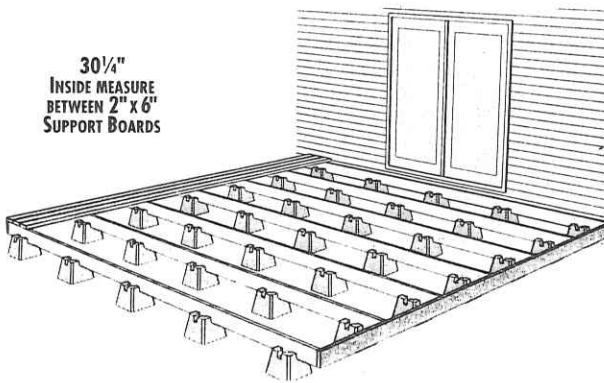

**20'x20' • 20'x24' • 20'x32' • 20'x40'**

MATERIALS	20'x20'	20'x24'	20'x32'	20'x40'
DEK-BLOCK BRAND PIERS	55	55	77	99
<b>SUPPORT BOARDS</b>				
10 FOOT 2"x6", TREATED LUMBER	22	—	—	44
12 FOOT 2"x6", TREATED LUMBER	—	22	—	—
16 FOOT 2"x6", TREATED LUMBER	—	—	22	—
<b>END BOARDS</b>				
16 FOOT 2"x6", TREATED LUMBER	2	2	2	2
<b>SURFACE BOARDS</b>				
8 FOOT 2"x6", TREATED LUMBER	43	52	68	85
12 FOOT 2"x6", TREATED LUMBER	43	52	68	85
*OPTIONAL POST'S FOR 30" ELEVATION				
8 FOOT 4"x4", TREATED LUMBER	8	11	11	14
2 1/2" GALV. DECK SCREWS	16 LBS	18 LBS	20 LBS	22 LBS
STAIN OR SEALER, GALLONS	5	6	8	10
METAL TRUSS PLATES	22	22	22	88

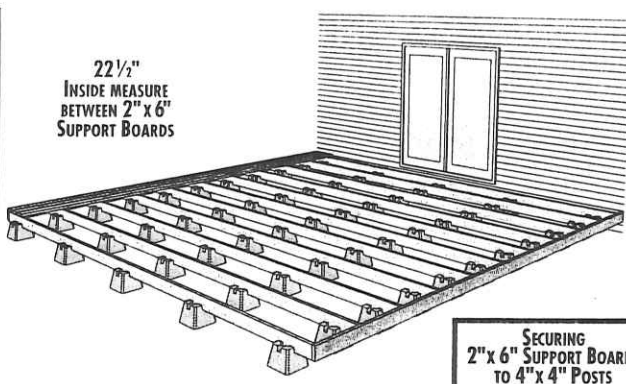

## HOW TO LEVEL OR LEVELATE YOUR DEK-BLOCK DECK

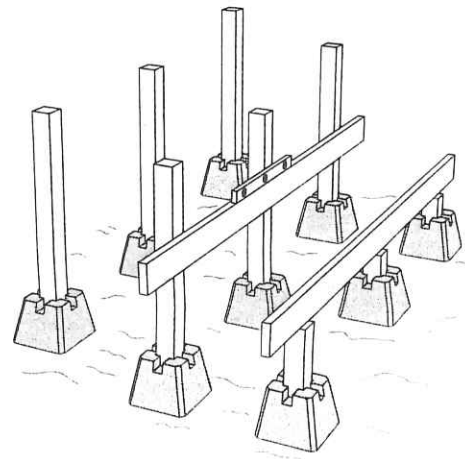

**1. Position DEK-Block piers.** Level the top of each DEK-Block pier, then insert 4"x4" posts. Get the inside measurement for the distance between posts from the plan for the deck size you've chosen.

**2. Determine height of deck with 2"x6" leveler.** Start at one side and work toward the other. Determine height of deck by tacking a 2"x6" leveler to the 4"x4" post at one end, then tacking the other end when the board is level. Top of 2"x6" leveler will be height of deck (plus an additional 1-3/4" when decking is applied). Mark 4"x4" posts along underside of 2"x6" leveler. Repeat for each row of leveling posts.

**3. Cut 4"x4" posts to length and position 2"x6" support boards.** Remove 4"x4" posts from DEK-Block piers. Cut to length at marks made in Step 2. Reinsert posts in piers. Center 2"x6" support board along tops of posts.

**4. Square up 2"x6" support boards and secure to 4"x4" posts.** Adjust outside support boards until diagonal distance between opposite corners is EQUAL and ends of all support boards are flush. Secure support boards to posts as shown.

### GOT ANY QUESTIONS?

- BUILDING CODES
- DECK HEIGHTS OVER 30"
- STAIRS, CUSTOM EXTENSIONS AND SHAPES, BUILT-IN PLANTERS
- USE WITH OUTDOOR HOT TUBS, PLACE TWO ADDITIONAL DEK-BLOCKS DIRECTLY UNDER HOT TUB

**TECHNICAL SUPPORT LINE  
1-800-664-2705**

### HOW TO SPACE DEK-BLOCK PIERS:

**With single 8', 10' and 12' support boards.** Space 3 Dek-Block piers along each support board as shown.

**With single 16' support boards.** Space 5 Dek-Block piers under each board as shown.

**When two or more support boards are joined end-to-end.** Support each support board at three points with Dek-Block piers as shown. Make sure that a Dek-Block pier is centered directly under each joint along the length of each support board.

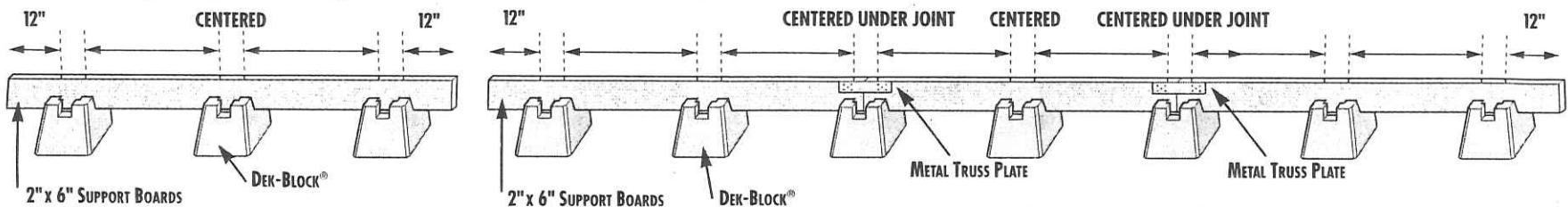

### HOW TO ADD A HANDRAIL

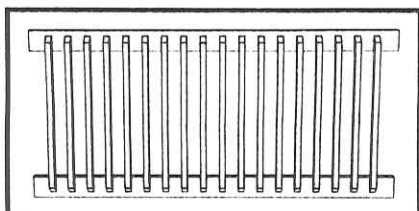

**STEP 1:** Position centers of outer 2"x2" boards 5" in from each end of 2"x6" handrail board, and attach with one 2 1/2" decking screw at the top. Attach bottom ends of 2"x2"s to deck support or facing board with two decking screws, using a level to ensure that 2"x2"s are plumb and

that 2"x6" handrail board is level with deck. Secure top of each 2"x2" to handrail with a second screw.

**STEP 2:** Position remaining 2"x2" boards on 5" centers, and secure with two 2 1/2" decking screws top and bottom.

MATERIALS (PER SIDE)	8'	10'	12'	16'	20'	24'	32'	40'
8 FOOT 2"x6" TREATED LUMBER	1	—	—	2	—	—	1	—
10 FOOT 2"x6" TREATED LUMBER	—	2	—	—	2	—	—	4
12 FOOT 2"x6" TREATED LUMBER	—	—	1	—	—	2	2	—
42 INCH 2"x2" TREATED LUMBER (BEVELED AT BOTH ENDS)	20	25	30	40	49	59	78	97
2 1/2" DECK SCREWS	1lb.	1lb.	2lbs.	2lbs.	2lbs.	3lbs.	3lbs.	4lbs.